

FLASHER ASSEMBLY INSTRUCTIONS

STEP 1 CUT OUT TEMPLATE AND TAPE IT TO YOUR VEHICLE

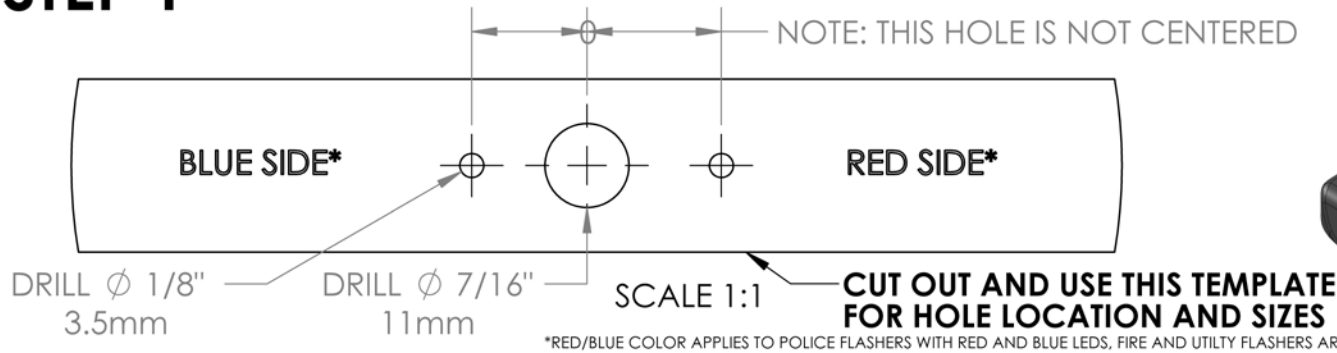

TAPE TO VEHICLE WHERE YOU WANT TO MOUNT YOUR FLASHER

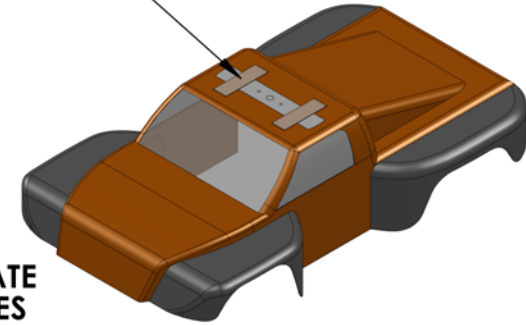

STEP 3 ASSEMBLE FLASHER AS SHOWN

STEP 2 DRILL HOLES IN BODY (WE RECOMEND USING A HAND DRILL AS SHOWN)

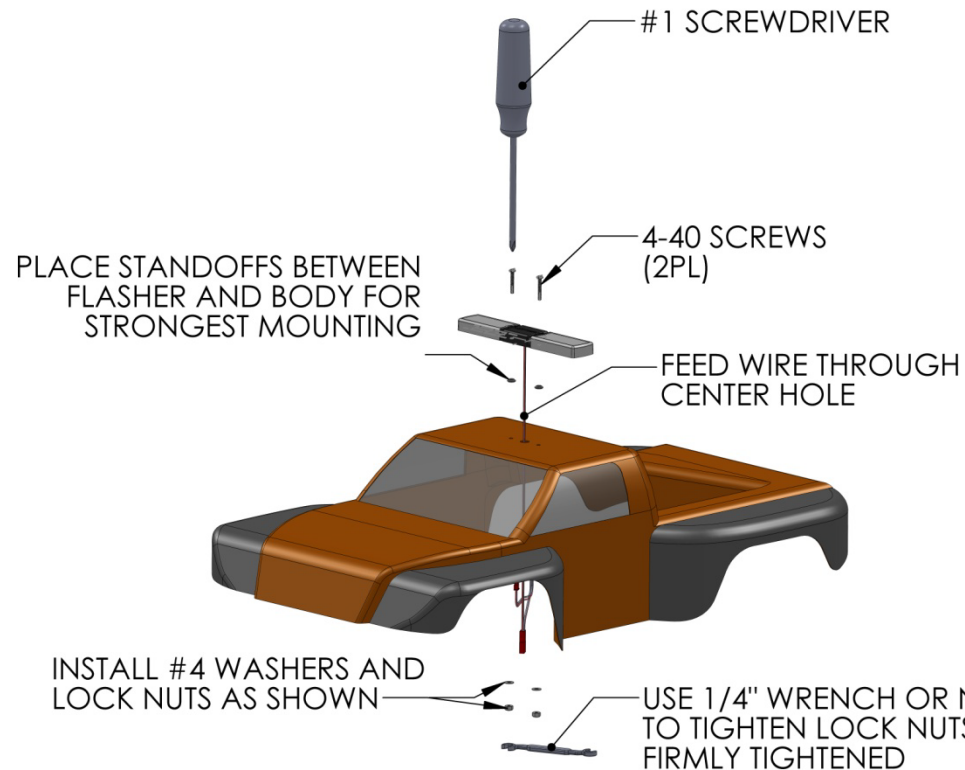
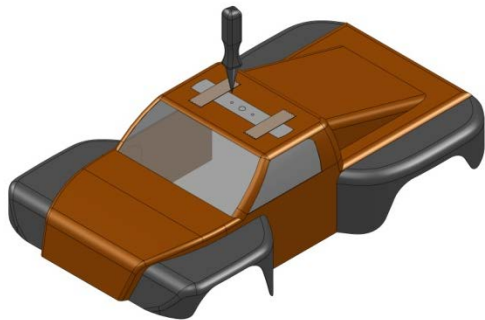

STEP 4 CONNECT FLASHER BAR TO UF-7 PIGTAIL OR 9V BATTERY**9V Battery Adapter**

The 9V Adapter Cable allows you to get power for your flasher from a 9V battery. Your 9V battery can be mounted to your vehicle using the included battery clip and thread forming screws. Simply drill a 1/16" pilot hole for each screw prior to installation.

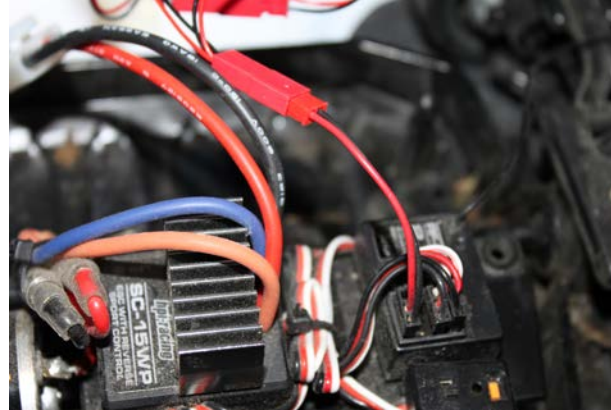
**3Pin Adapter Cable**

3pin adapter cable allows you to get power directly from your car's battery using the controller found on certain vehicles. In some cases the 3pin plug is readily visible on the controller (as shown above), but on waterproof vehicles it may be located under a cover. If this is the case, simply remove the cover, connect the 3 pin Adapter Cable, then re-install the cover leaving red 2-pin connector hanging outside for the flasher.

NOTE- If your flasher doesn't work the cable may be plugged in backwards. Remove the cable, rotate it 180deg and reinstall.

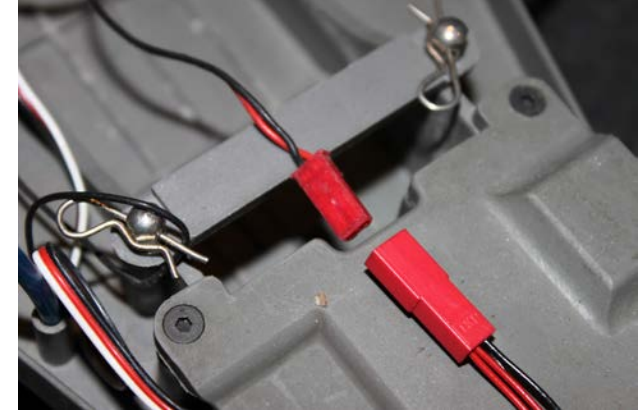
**2Pin Configuration**

If your vehicle has a 2pin cable then you can plug your flasher directly into it as shown. This draws power directly from the vehicle's battery.

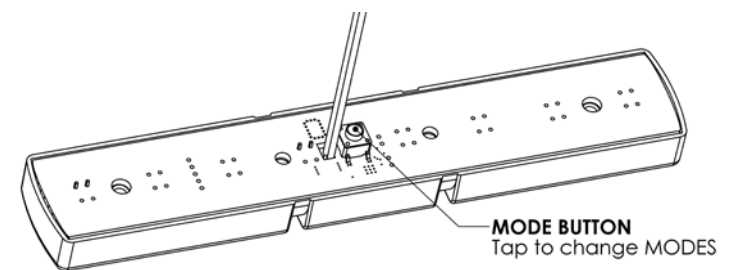
MODE BUTTON- To change flash patterns

MODE BUTTON
Tap to change MODES